



LIGHTEN YOUR LOAD

Say goodbye to external hubs and expensive interconnect cables. WedgeX introduces dynamic, system-wide power, data, and device management capabilities in a single device. Its modular design allows warfighters to quickly and easily adjust their communications kit for various mission profiles, whether it's short duration, extended power, or precision targeting configurations.

SIDELINK
MODULAR RADIO
HUB ADAPTER

RADIO ADAPTER

WEDGE ADAPTER

EXTEND RUN-TIME, EFFORTLESSLY

WedgeX continuously monitors the state of charge and real-time power requirements to balance the load of on-body devices, even scavenging power from lower-priority devices when needed. Enhanced capabilities includes emergency reserve time and device priority, to ensure optimized run-time and enabling warfighters to stay on their rifles.

WEDGE^X

ADAPTS YOUR COMMS SYSTEM TO YOU, NOT YOU TO IT.

INNOVATING FOR THE WARFIGHTER

Freedom Atlantic and OTTO Engineering have co-developed WedgeX to provide warfighters with a significant tactical EDGE. This innovative solution redefines radio power and data distribution, ensuring rapid adaptability, extended run-time, and lighter loadouts.

 DESIGNED, TESTED,
AND BUILT IN THE U.S.A.

freedom-atlantic.com | DIRECT: 1.517.300.2760 | info@freedom-atlantic.com

WEDGE^X

ADAPTS YOUR COMMS SYSTEM TO YOU, NOT YOU TO IT.

LIGHTEN YOUR LOAD
EXTEND EQUIPMENT RUNTIME
RECONFIGURE QUICKLY



Co-developed by Freedom Atlantic and OTTO Engineering to give warfighters the extra edge.



FREEDOMATLANTIC

OTTO

WARFARE HAS EVOLVED

Today's battlefields have become increasingly decentralized and unpredictable, with mission requirements constantly evolving in response to fresh intelligence. To adapt, warfighters have traditionally manually configured their comms kits for each mission and carry extra devices, adapters, and backup batteries.

This load is carried both physically and mentally, and loss of attention for equipment management or overlooked power drains—like unchecked devices, expired batteries, or unexpected challenges—can risk splitting the soldier's attention.

WEDGEX ENABLES YOU TO:

- + LIGHTEN YOUR LOAD
- + EXTEND EQUIPMENT RUNTIME, EFFORTLESSLY
- + RECONFIGURE QUICKLY

RECONFIGURE QUICKLY

The system's modular design allows warfighters to easily and rapidly adjust their comms kit based on specific mission profiles. Its universal adapter and configurable interface ensure compatibility with various devices, while advanced port options support a wide range of communication and power needs.



ALL-IN-ONE SYSTEM

Designed for seamless interoperability, WedgeX is a configurable data hub and dynamic power controller in one, the system streamlines equipment setup and eliminate extraneous cables and devices common to traditional hub-and-spoke architectures.

WEDGEX
SIDELINK
MODULAR RADIO HUB ADAPTER

WEDGEX SYSTEM

- + RADIO POWER ADAPTER
- + SIDELINK MODULAR RADIO HUB ADAPTER
 - RADIO SIDE ADAPTER
 - WEDGE MODULE ADAPTER
- + ATAK POWER MANAGEMENT APP

RADIO POWER ADAPTER

MULTI-MISSION MODULARITY

The WedgeX Radio Power Adapter seamlessly integrates with the SIDELINK Modular Radio Hub Adapter for efficient power management and device negotiation at every interface. System software adapts various devices for use through simple settings adjustments. WedgeX is equipped to support a wide range of communication and power needs.

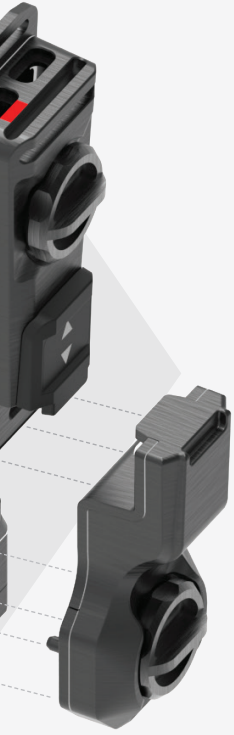

WedgeX allows configuration of the kit parameters to specific mission profiles.

LEGACY CONFIGURATION (Single Radio)

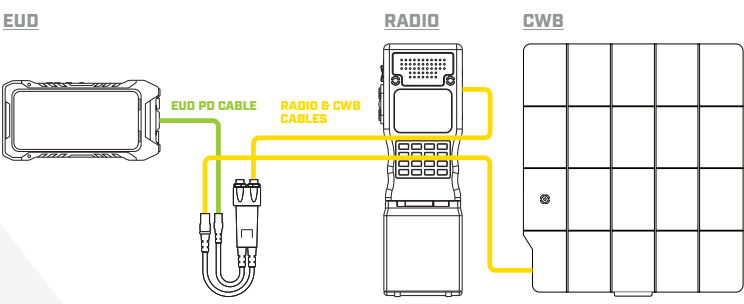

WEDGEX CONFIGURATION (Single Radio)

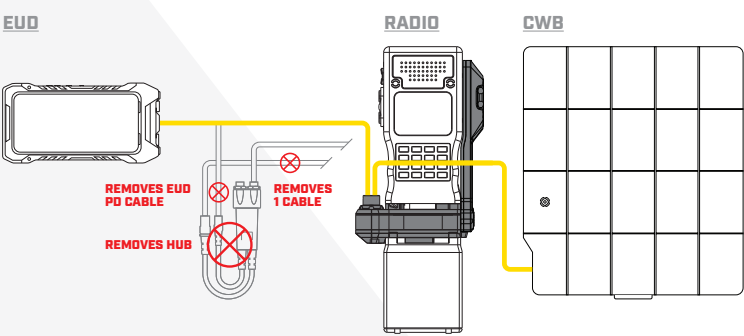

POWER AND DATA OVER A SINGLE CABLE